

# ARTSCAPE GIBRALTAR POINT

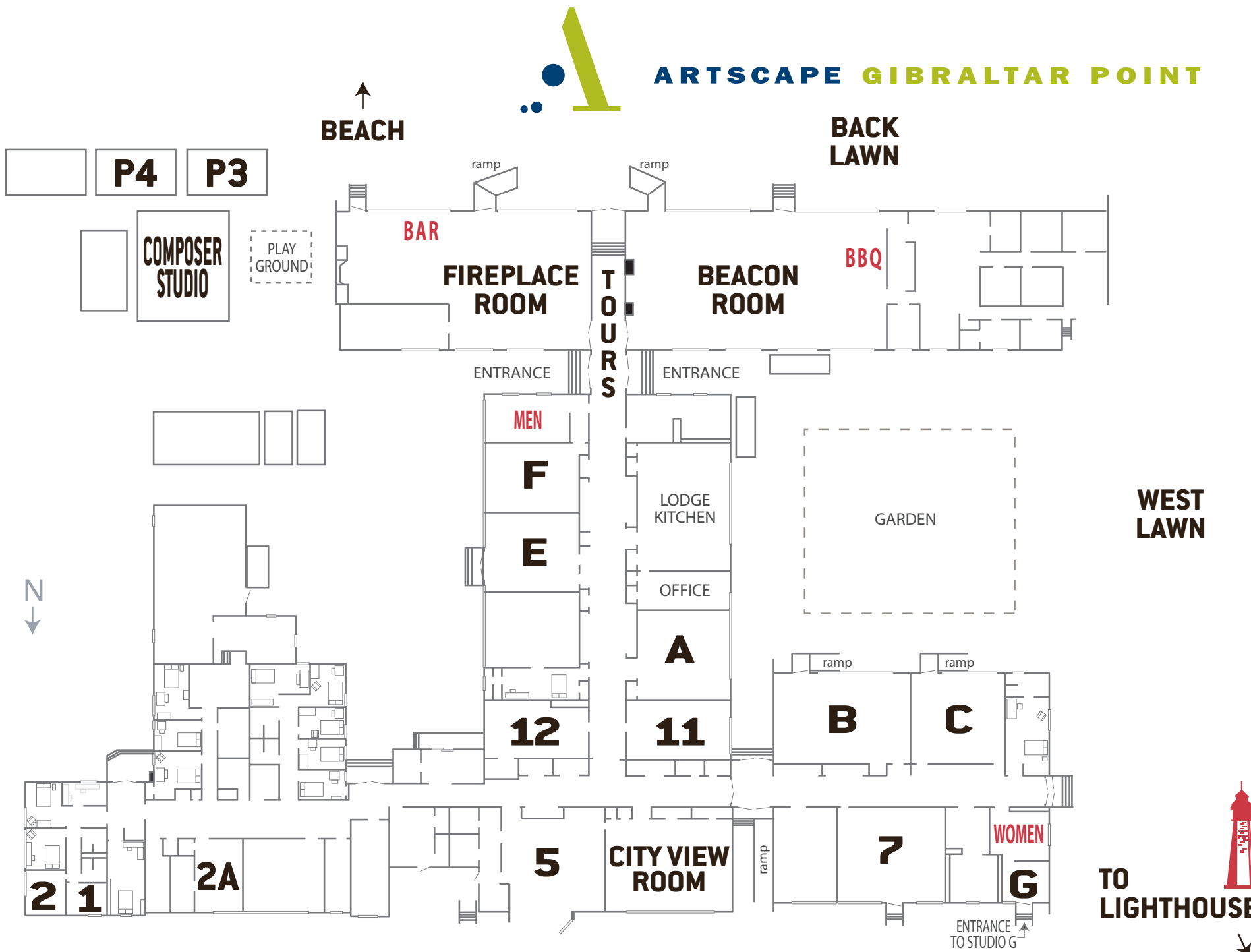

# 100<sup>th</sup> ANNIVERSARY

Friday, September 25, 2009

### SHUTTLES TO FERRY



A series of **three** Shuttle Bus trips have been scheduled to take visitors from Artscape Gibraltar Point to the Ferry Docks leaving the driveway at the following times:

- 7:30pm**  
7:45 ferry departing from Centre Island
- 9:00pm**  
9:15 ferry departing from Hanlan's Point
- 10:00pm**  
10:15 ferry departing from Hanlan's Point

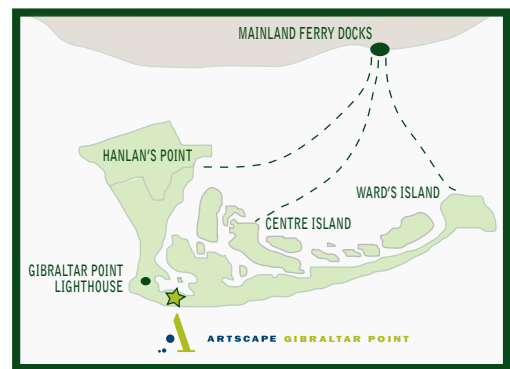



## SCHEDULE

### 5:30PM Ferry Docks

Shadowland procession to Artscape Gibraltar Point from Centre Island ferry

### 6:00-10:00PM Beacon Room

Looped films, BBQ

### 6:00-10:00PM Fireplace Room

Performers/BAR/DJ Dale Morningstar

### 6:00PM LIGHTHOUSE

Performance piece

### 6:00-10:00PM STUDIOS/HALLWAYS

Open studios, performances

### 6:30-7:00PM Fireplace Room

Celia Smith, Artscape Vice President of Operations, L. Robin Cardozo, Ontario Trillium Foundation

### 7:05, 7:35, 8:05PM

#### Outside Fireplace Room

Performance Tours

### 8:00-8:30PM

Fireplace Room Readings

### 8:30-9:00PM Fireplace Room

Greetings from Tim Jones, Artscape President and CEO; Island Committee Tribute with Leida Englar and Julie Stone

### 9:00-10:00PM BEACH

Bonfire/Music/Readings/Performances

## PARTICIPATING ARTISTS

### CENTRE ISLAND FERRY DOCK

Shadowland's band will greet guests on the 5:30pm ferry to Centre Island. Guests will enjoy a musical performance while taking the infamous beltline and be welcomed at Centre Island by Shadowland's stilt walking procession to Artscape Gibraltar Point.

### BEACON ROOM

BBQ: Hamburgers, corn-on-the-cob & pop: \$6.50

LOOPED FILMS: **Shadowland Theatre:** *Right of Passage*, 2000; **Kathleen Doody:** *The Burning of Trees*, 2009; **Velcrow Ripper:** *Burn*, 2001; **Brad Harley & Mike Davey:** *Snow Cones*, soundtrack by **Michael Snow**, 2002; **Jacky Sawatzky, Sarah Dorckenwald, Sebastian Sorge:** *Bildergeschichte*; **Kathleen Doody:** *Deenie & Freda's Garden*; **Lien-Chen Lin:** *Reserved Voyage: Somewhere & Nowhere=Everywhere*, 2006-2007; **Wende Bartley:** *Ancestral Landing*, 2009

### FIREPLACE ROOM

BAR: Beer & Wine: \$4.00

FRIENDS OF ARTSCAPE EXHIBIT: **Jane Adams, Gnocchi Artyst, Yuula Benivolski, Jim Bravo, Yael Brotman, Emily Colquhoun, Mitch Fenton, Libby Hague, Colleen Lynch, Nola McConnan, Luisa Milan, Zeesy Powers, David Smiley, Julie Stone, Ramon Serrano.**

**Jacquey Malcolm**, cello performance: 7:50-8:00pm

**Guy Ewing, Julia Tausch, Mary Lou Zeitoun**, readings: 8:00-8:30pm

PERFORMANCE TOURS: 7:05, 7:35, 8:05pm **Lo Bil** A performance artist, playwright, poet and facilitator takes you on a journey of stories generated by the old island school and Artscape Gibraltar Point. Meet outside the Fireplace Room.

### CITY VIEW ROOM

Re-creation of old school classroom, in conversation with **Gary Fairfoul**.

### HALLWAYS

TORONTO ISLAND ARCHIVES: A three week exhibition featuring photographs from the Toronto Island Archives collection. Witness 100 years of Island history at this curated show.

### WEST LAWN

**Patrick DeCoste** Video projection onto painted linen 8 x 20 feet. *Neptune and Kluskap*, 2009. Part of a project funded by the Canada Council for the Arts.

**Warren Hoselton** Parks Supervisor and bike enthusiast, installation piece, *Tour des Tree*.

### LIGHTHOUSE 6:00pm

**Pam Patterson, Leena Raudvee, John Oughton** Performance piece, "At The Lighthouse" What would happen if Virginia Woolf hadn't committed suicide? Accompanied by her sister Vanessa Bell (who has now turned to digital photography and collage from painting) & Lytton Strachey (reduced to writing poetry under the pseudonym of Canadian poet John Oughton), they gather at the Lighthouse. Join this Bloomsbury group with tea and culture at the Lighthouse at Gibraltar Point.

### GIBRALTAR BEACH 9:00pm

Bonfire; **Jason Benoit**, banjo; **JD Pipher**, reading; **Yuula Benivolski as Solar Zinc & Lisa Cristinzo as Beasta Wilda**, performance/fire ritual: 9:15pm.

## Friday, September 25, 2009

### OPEN STUDIOS 6:00-10:00pm

**STUDIO A: Toronto Island Archives** Curated by islanders **Emily Fulton, Adam Zhelka and Peter Holt**. A three week exhibition featuring photographs from the Toronto Island Archives collection.

**STUDIO B: Susan Gardner** Painter, photographer and poet whose art is infused with lyrical spontaneity as she explores and illuminates the relationships between individuals, society and nature. Reading 7:00pm.

**STUDIO C: Pat Jefferies** exhibiting painted portraits of Toronto Island trees.

**STUDIO E: Ilias Toliadis** Greek heritage, landscape paintings of the newly discovered Toronto Island.

**STUDIO F: Yuula Benivolski** works with sculpture, photographs, video and installation; **Sarah Pupo** Video installation, *the passing*. **Wende Bartley, Jacky Sawatzky, Deborah Bordey & Katherine Malone** Performance piece, *Ode to Stanley Park*. Performance at 7:00pm & 7:45pm.

**STUDIO G: James Oshanghnessy** Digital photographer and student at Ryerson University. "My photos emphasize the natural elements regardless of location, the subject is usually the water, trees, sand or clouds in the sky."

**STUDIO 1: Helena Kvarnstrom** Writer and photographer living in Toronto. Video installation of *A Siamese Cat Would Be So Small*.

**STUDIO 2: Ryan Noth** Video installation, *The National Parks Project: Gros Morne*, with music by **Dale Morningstar & Andrew Whiteman** from Apostle of Hustle & Broken Social Scene.

**STUDIO 2A: Talia Erlich** Interactive eco piece, looped video *In Case of Fire*.

**STUDIO 5: Megan English** Dancer and choreographer, interactive looped video.

**STUDIO 7: Marsha Stonehouse** Painter, Creativity Facilitator & Reiki Master; **Jacky Sawatzky** "intimate irrelevant moments", mixed media collages.

**STUDIO 11: Alastair Dickson** Sculptor and winner of the 2002 Cannes Film Festival's Prix Du Jury for *The Stone of Folly* created with **Jesse Rosensweet**.

**STUDIO 12: Wende Bartley**, Composer, performer and sound artist.

**COMPOSER STUDIO: Doug Tielli** A multi-instrumentalist (trombone, guitar, banjo, keyboards, junk, etc.) he finds himself on the edges of many musical practices (free-improvisation, composition, song writing, jazz, pop, country and noise). He is currently a member of The Silt, The Reveries, The Draperies, Drumheller and No Man Band.

**PORTABLE 3 (P3): Anna Friz** Sound and radio artist who creates dynamic, atmospheric sound works for theatre, dance and solo performance that are equally able to reflect upon public media culture or to reveal interior landscapes.

**PORTABLE 4 (P4): David Pellettier** Sculptor who has exhibited extensively internationally with exhibitions in the Art Gallery of Nova Scotia and the Galerie Du Musee du Quebec. His work is included in a number of collections including the Art Gallery of Hamilton.